

PROVIDED IN "NORTH KINGSTOWN FACILITIES SURVEY" PREPARED BY "DESIGN GROUP INC." DATED APRIL 1994, AND VERIFIED IN THE FIELD BY THE ROBINSON GREEN BERETTA CORP. IN JUNE 2003

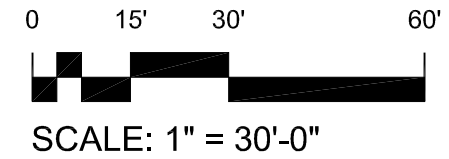

This drawing is copyrighted and is subject to copyright protection as an "architectural work" under 17 U. S. C. Sec. 101 et seq. The protection includes but is not limited to the overall form as well as the arrangement and composition of spaces, materials, color and elements in the design. Under such protection, unauthorized use of this drawing may result in the cessation of construction or buildings being seized and/or monetary compensation being awarded to The Robinson Green Beretta Corporation (RGB).

Any reproduction, possession, or use of this drawing or any part thereof without the express written permission of RGB is prohibited. Violators will be prosecuted to the full extent of the law.

© RGB 2007

Certification

Drawn by TAD
Checked by DLD

Revised on

The Robinson Green Beretta Corporation

architecture
engineering
interior design

50 Holden Street
Providence, Rhode Island
Phone: 401 272 1730
401 273 7156
www.RGB.net
rgb@rgb.net

Project

**Proposed Plans for
Wickford Middle School**

99 Phillips Street
North Kingstown, Rhode Island

Drawing Status:
For Pricing 18 JAN 07

Sheet Contents
GROUND FLOOR
PROPOSED
SCHEME C
Project Number. 5572

Drawing No.
A100

Sheet of

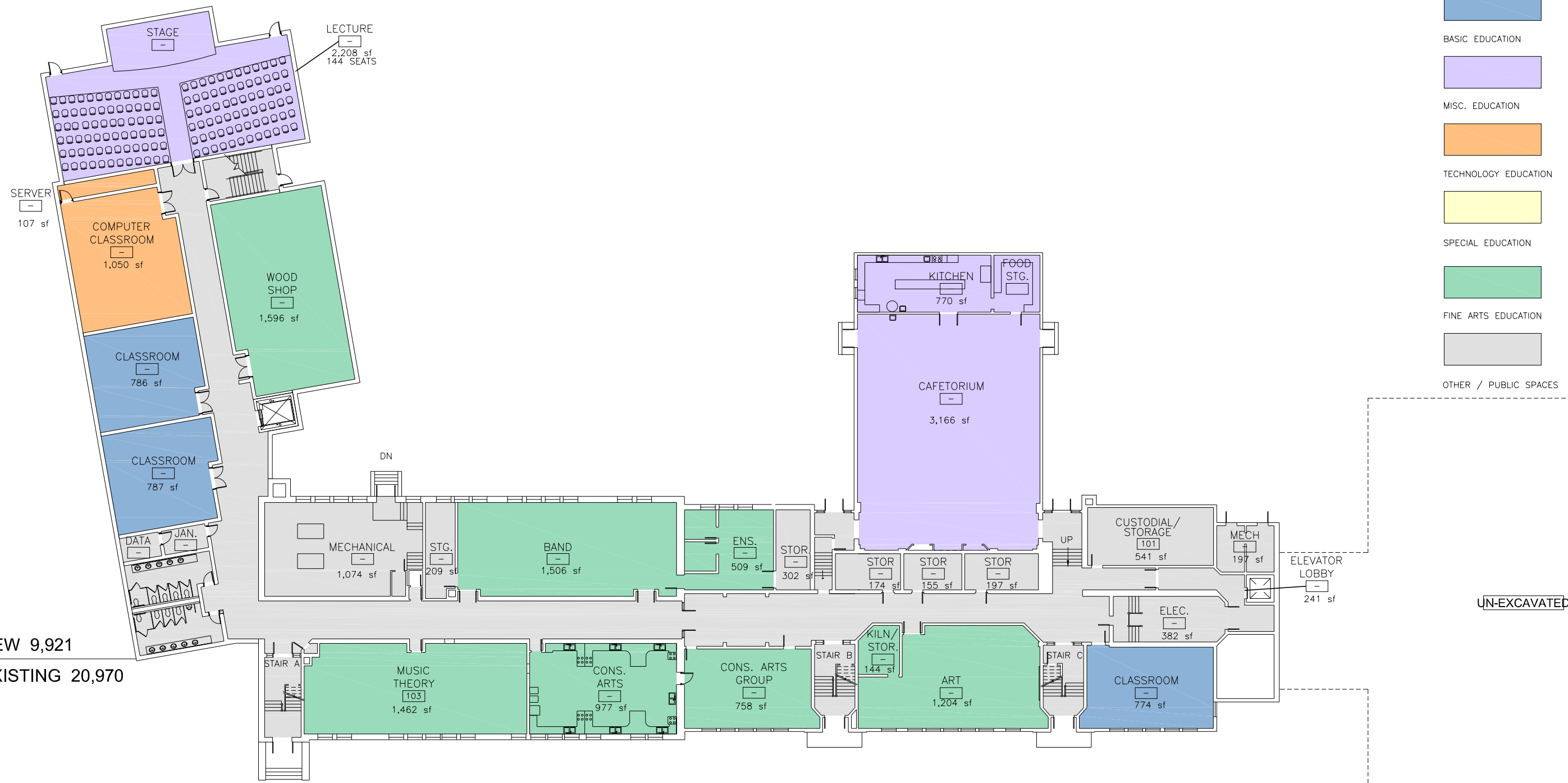

Ground Floor Level
GROSS AREA = 30,891 +/-S.F.

NEW 9,921
EXISTING 20,970

UN-EXCAVATED